

M

Describe any additional steps you intend to take to promote the four licensing objectives as a result of the proposed variation:

a) General – all four licensing objectives (b, c, d and e) (please read guidance note 10)

b) The prevention of crime and disorder

--

c) Public safety

d) The prevention of public nuisance

--

e) The protection of children from harm

--

Checklist:

Please tick to indicate agreement

- I have made or enclosed payment of the fee, or I have not made or enclosed payment of the fee because this application has been made in relation to the introduction of the late night levy.
- I have sent copies of this application and the plan to responsible authorities and others where applicable.
- I understand that I must now advertise my application.
- I have enclosed the premises licence or relevant part of it or explanation.
- I understand that if I do not comply with the above requirements my application will be rejected.

IT IS AN OFFENCE, LIABLE ON SUMMARY CONVICTION TO A FINE NOT EXCEEDING LEVEL 5 ON THE STANDARD SCALE, UNDER SECTION 158 OF THE LICENSING ACT 2003, TO MAKE A FALSE STATEMENT IN OR IN CONNECTION WITH THIS APPLICATION.

Part 5 – Signatures (please read guidance note 11)

Signature of applicant (the current premises licence holder) or applicant's solicitor or other duly authorised agent (please read guidance note 12). If signing on behalf of the applicant, please state in what capacity.

Signature	<i>Naureen Bawa</i>
Date	<i>20-05-2014</i>
Capacity	<i>Director</i>

Where the premises licence is jointly held, signature of 2nd applicant (the current premises licence holder) or 2nd applicant's solicitor or other authorised agent (please read guidance note 13). If signing on behalf of the applicant, please state in what capacity.

Signature	
Date	
Capacity	

Contact name (where not previously given) and address for correspondence associated with this application (please read guidance note 14)

Post town		Post code	
Telephone number (if any)			
If you would prefer us to correspond with you by e-mail, your e-mail address (optional)			

Notes for Guidance

This application cannot be used to vary the licence so as to extend the period for which the licence has effect or to vary substantially the premises to which it relates. If you wish to make that type of change to the premises licence, you should make a new premises licence application under section 17 of the Licensing Act 2003.

1. You do not have to pay a fee if the only purpose of the variation for which you are applying is to avoid becoming liable to the late night levy.
2. Describe the premises. For example the type of premises, its general situation and layout and any other information which could be relevant to the licensing objectives. Where your application includes off-supplies of alcohol and you intend to provide a place for consumption of these off-supplies, you must include a description of where the place will be and its proximity to the premises.
3. Where taking place in a building or other structure please tick as appropriate (indoors may include a tent).
4. For example state type of activity to be authorised, if not already stated, and give relevant further details, for example (but not exclusively) whether or not music will be amplified or unamplified.
5. For example (but not exclusively), where the activity will occur on additional days during the summer months.
6. For example (but not exclusively), where you wish the activity to go on longer on a particular day e.g. Christmas Eve.
7. Please give timings in 24 hour clock (e.g. 16:00) and only give details for the days of the week when you intend the premises to be used for the activity.
8. If you wish people to be able to consume alcohol on the premises, please tick 'on the premises'. If you wish people to be able to purchase alcohol to consume away from the premises, please tick 'off the premises'. If you wish people to be able to do both, please tick 'both'.
9. Please give information about anything intended to occur at the premises or ancillary to the use of the premises which may give rise to concern in respect of children regardless of whether you intend children to have access to the premises, for example (but not exclusively) nudity or semi-nudity, films for restricted age groups or the presence of gaming machines.
10. Please list here steps you will take to promote all four licensing objectives together.
11. The application form must be signed.
12. An applicant's agent (for example solicitor) may sign the form on their behalf provided that they have actual authority to do so.
13. Where there is more than one applicant, each of the applicants or their respective agents must sign the application form.
14. This is the address which we shall use to correspond with you about this application.

Dunston Inn, Dunston Lane, Dunston,
Chesterfield, Derbyshire, S41 8HA

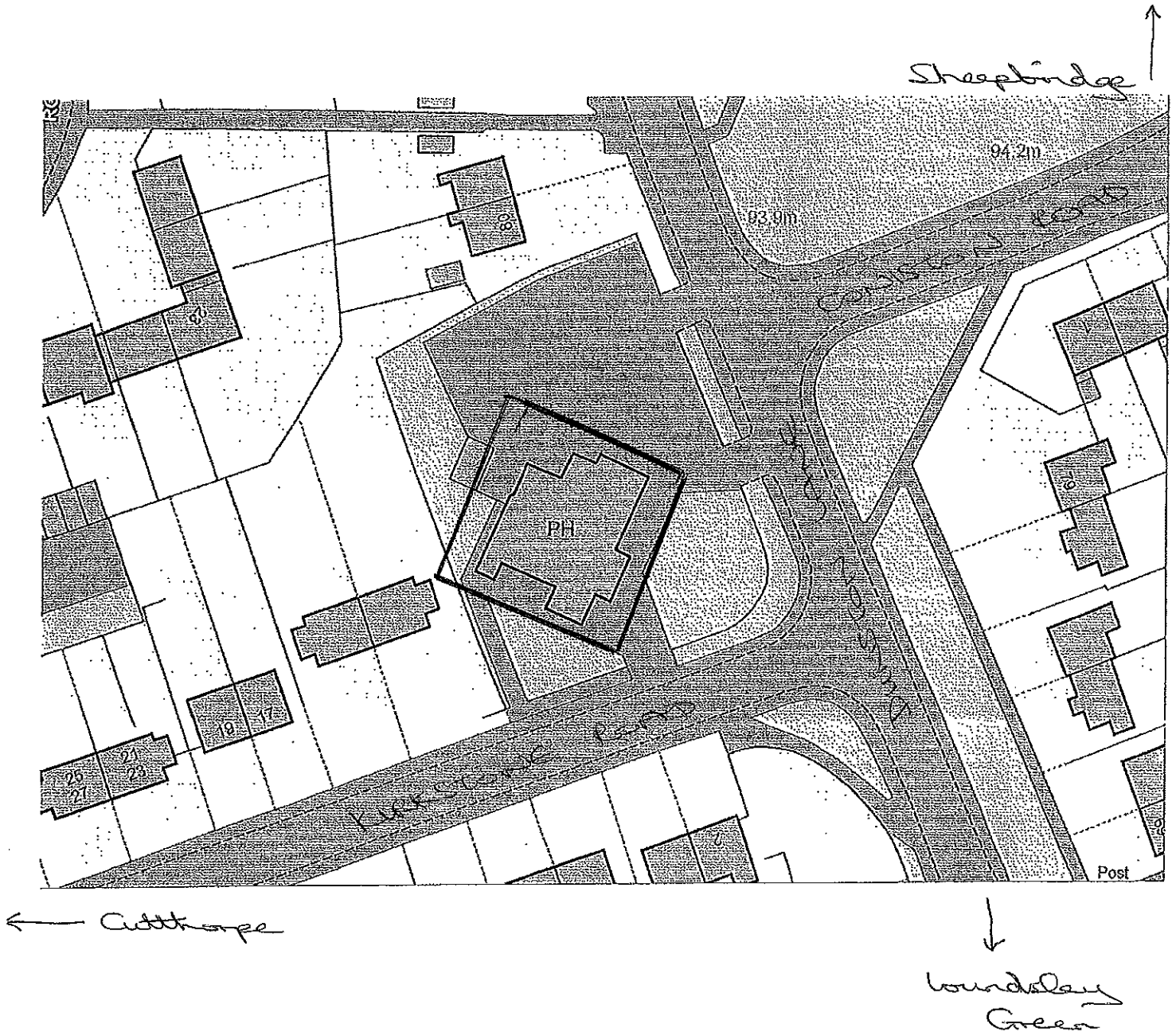

This product includes mapping data licensed from Ordnance Survey with the permission of the Controller of Her Majesty's Stationary Office. © Crown copyright and/or database right 2006. All rights reserved. License number 100018505



Chesterfield Borough Council

Environment Services
Customer Service Centre
85 New Square
Chesterfield
S40 1AH

Telephone: 01246 345230
Fax: 01246 345235
licensing@chesterfield.gov.uk

Licensing Act 2003

Premises Licence

PL/VF/0281

Part 1 - Premises Details

POSTAL ADDRESS OF PREMISES, OR IF NONE, ORDANCE SURVEY MAP REFERENCE OR DESCRIPTION

Dunston Inn

Dunston Lane, Newbold, Chesterfield, Derbyshire, S41 8HA.

Telephone 01246 453083

WHERE THE LICENCE IS TIME LIMITED THE DATES

Not applicable

Granted 20/10/2005

LICENSABLE ACTIVITIES AUTHORISED BY THE LICENCE

- an exhibition of a film
- an indoor sporting event
- a performance of live music
- any playing of recorded music
- a performance of dance
- entertainment facilities for making music
- entertainment facilities for dancing
- provision of late night refreshment
- the sale by retail of alcohol

THE TIMES THE LICENCE AUTHORISES THE CARRYING OUT OF LICENSABLE ACTIVITIES

Activity (and Area if applicable)	Description	Time From	Time To
B. Exhibition of films (Indoors)	Monday to Sunday Non Standard Timings: When the hours for sale of alcohol are extended hereunder these hours are also extended.	7:00pm	Midnight
C. Indoor sporting event	Monday to Saturday Sunday Non Standard Timings: When the hours for sale of alcohol are extended hereunder these hours are also extended.	10:00am Noon	1:00am Midnight
E. Performance of live music (Indoors)	Monday to Sunday Non Standard Timings: When the hours for sale of alcohol are extended hereunder these hours are also extended.	7:00pm	Midnight
F. Playing of recorded music (Indoors)	Monday to Sunday Non Standard Timings: When the hours for sale of alcohol are extended hereunder these hours are also extended.	7:00pm	Midnight
G. Performance of dance (Indoors)	Monday to Sunday Non Standard Timings: When the hours for sale of alcohol are extended hereunder these hours are also extended.	7:00pm	Midnight





Chesterfield Borough Council

Environment Services
 Customer Service Centre
 85 New Square
 Chesterfield
 S40 1AH

Telephone: 01246 345230
 Fax: 01246 345235
 licensing@chesterfield.gov.uk

Licensing Act 2003

Premises Licence

PL/VF/0281

THE TIMES THE LICENCE AUTHORISES THE CARRYING OUT OF LICENSABLE ACTIVITIES continued

Activity (and Area if applicable)	Description	Time From	Time To
I. Provision of facilities for making music (Indoors)	Monday to Saturday	10:00am	1:00am
	Sunday	Noon	Midnight
	Non Standard Timings:		
	When the hours for sale of alcohol are extended hereunder these hours are also extended.		
J. Provision of facilities for dancing (Indoors)	Monday to Sunday	7:00pm	Midnight
	Non Standard Timings:		
	When the hours for sale of alcohol are extended hereunder these hours are also extended.		
L. Late night refreshment (Indoors)	Monday to Saturday	11:00pm	1:00am
	Sunday	11:00pm	Midnight
	Non Standard Timings:		
	When the hours for sale of alcohol are extended hereunder these hours are also extended.		
M. The sale by retail of alcohol for consumption ON and OFF the premises	Monday to Saturday	10:00am	1:00am
	Sunday	Noon	Midnight
	Non Standard Timings:		
	New Year's Eve: 10.00 to New Year's Day - terminal hour as proposed.		
On Bank Holiday Sundays and when Christmas Eve and Boxing Day falls on a Sunday the terminal hour will be 01.00 rather than midnight.			

THE OPENING HOURS OF THE PREMISES

Description	Time From	Time To
Monday to Saturday	10:00am	1:30am
Sunday	Noon	12:30am
Non Standard Timings:		
The premises will close 30 minutes after the end of the non-standard timings for the sale of alcohol.		

WHERE THE LICENCE AUTHORISES SUPPLIES OF ALCOHOL WHETHER THESE ARE ON AND / OR OFF SUPPLIES

- M. The sale by retail of alcohol for consumption ON and OFF the premises

Part 2

NAME (REGISTERED) ADDRESS TELEPHONE NUMBER AND EMAIL (WHERE RELEVANT) OF HOLDER OF PREMISES LICENCE

Manvesh Enterprise Ltd
 sekhanbs2@gmail.com

305 Grampian Way, Derby, DE24 3JH.
 Telephone 07455002770

REGISTERED NUMBER OF HOLDER, FOR EXAMPLE COMPANY NUMBER CHARITY NUMBER (WHERE APPLICABLE)

Manvesh Enterprise Ltd

08531599





Chesterfield Borough Council

Environment Services
Customer Service Centre
85 New Square
Chesterfield
S40 1AH

Telephone: 01246 345230
Fax: 01246 345235
licensing@chesterfield.gov.uk

Licensing Act 2003

Premises Licence

PL/VF/0281

NAME, ADDRESS AND TELEPHONE NUMBER OF DESIGNATED PREMISES SUPERVISOR WHERE THE PREMISES LICENCE AUTHORIZES THE SUPPLY OF ALCOHOL

Navpreet BAINS

The Dunston Inn, Dunston Lane, Chesterfield, Derbyshire, S41 8HA.

PERSONAL LICENCE NUMBER AND ISSUING AUTHORITY OF PERSONAL LICENCE HELD BY DESIGNATED PREMISES SUPERVISOR WHERE THE PREMISES LICENCE AUTHORIZES FOR THE SUPPLY OF ALCOHOL

Licence No. 028284

Issued by Sandwell

ANNEXES

ANNEX 1 - MANDATORY CONDITIONS

Retailing of Alcohol

1. No supply of alcohol may be made under the premises licence -

- (a) at a time when there is no designated premises supervisor in respect of the premises licence, or
- (b) at a time when the designated premises supervisor does not hold a personal licence or his personal licence is suspended.

2. Every supply of alcohol under the premises licence must be made or authorised by a person who holds a personal licence.

Irresponsible Promotions

3. The responsible person shall take all reasonable steps to ensure that staff on the licensed premises do not carry out, arrange or participate in any irresponsible promotions in relation to the premises. In this condition, an irresponsible promotion means any one or more of the following activities, or substantially similar activities, carried on for the purpose of encouraging the sale or supply of alcohol for consumption on the premises in a manner which carries a significant risk of leading or contributing to crime and disorder, prejudice to public safety, public nuisance, or harm to children-

(a) games or other activities which require or encourage, or are designed to require or encourage, individuals to-

- (i) drink a quantity of alcohol within a time limit (other than to drink alcohol sold or supplied on the premises before the cessation of the period in which the responsible person is authorised to sell or supply alcohol), or





Chesterfield Borough Council

Environment Services
Customer Service Centre
85 New Square
Chesterfield
S40 1AH

Telephone: 01246 345230
Fax: 01246 345235
licensing@chesterfield.gov.uk

Licensing Act 2003

Premises Licence

PL/VF/0281

ANNEXES continued ..

- (ii) drink as much alcohol as possible (whether within a time limit or otherwise);
- (b) provision of unlimited or unspecified quantities of alcohol free or for a fixed or discounted fee to the public or to a group defined by a particular characteristic (other than any promotion or discount available to an individual in respect of alcohol for consumption at a table meal, as defined in section 159 of the Act);
- (c) provision of free or discounted alcohol or any other thing as a prize to encourage or reward the purchase and consumption of alcohol over a period of 24 hours or less;
- (d) provision of free or discounted alcohol in relation to the viewing on the premises of a sporting event, where that provision is dependent on-
 - (i) the outcome of a race, competition or other event or process, or
 - (ii) the likelihood of anything occurring or not occurring;
- (e) selling or supplying alcohol in association with promotional posters or flyers on, or in the vicinity of, the premises which can reasonably be considered to condone, encourage or glamorise anti-social behaviour or to refer to the effects of drunkenness in any favourable manner.

Dispensing alcohol directly into the mouth

4. The responsible person shall ensure that no alcohol is dispensed directly by one person into the mouth of another (other than where that other person is unable to drink without assistance by reason of a disability).

Free tap water

5. The responsible person shall ensure that free tap water is provided on request to customers where it is reasonably available.

In conditions numbered 3, 4 and 5 above, "responsible person" means-

- (i) the holder of a premises licence in respect of the premises,
- (ii) the designated premises supervisor (if any) under such a licence, or
- (iii) any individual aged 18 or over who is authorised for the purposes of this section by such a holder or supervisor.





Chesterfield Borough Council

Environment Services
Customer Service Centre
85 New Square
Chesterfield
S40 1AH

Telephone: 01246 345230
Fax: 01246 345235
licensing@chesterfield.gov.uk

Licensing Act 2003

Premises Licence

PL/VF/0281

ANNEXES continued

Age-verification

6. (1) The premises licence holder or club premises certificate holder shall ensure that an age verification policy applies to the premises in relation to the sale or supply of alcohol.

(2) The policy must require individuals who appear to the responsible person to be under 18 years of age (or such older age as may be specified in the policy) to produce on request, before being served alcohol, identification bearing their photograph, date of birth and a holographic mark.

Smaller Measures

7. The responsible person shall ensure that-

(a) where any of the following alcoholic drinks is sold or supplied for consumption on the premises (other than alcoholic drinks sold or supplied having been made up in advance ready for sale or supply in a securely closed container) it is available to customers in the following measures-

- (i) beer or cider: ½ pint;
 - (ii) gin, rum, vodka or whisky: 25 ml or 35 ml; and
 - (iii) still wine in a glass: 125 ml; and
- (b) customers are made aware of the availability of these measures.

Exhibition of Films

The admission of any person aged under 18 to the exhibition of any film at the premises is restricted in accordance with Section 20 of the Licensing Act 2003.

Door Supervision

Each individual carrying out a security activity at the premises must be licensed by the Security Industry Authority.

ANNEX 2 - CONDITIONS CONSISTENT WITH THE OPERATING SCHEDULE

An application for an Expedited Review was submitted to the Council on 10th May 2011.

The following text is from the Operating Schedule (as later expanded upon by the Applicant).

General - All Four Licensing Objectives





Chesterfield Borough Council

Environment Services
Customer Service Centre
85 New Square
Chesterfield
S40 1AH

Telephone: 01246 345230
Fax: 01246 345235
licensing@chesterfield.gov.uk

Licensing Act 2003

Premises Licence

PL/VF/0281

ANNEXES continued...

I have undertaken my own risk assessment to take the following proposed steps. The types of regulated entertainment proposed materially do no more than reinstate the normal pub entertainment that was previously unregulated as identified in part 3 above. No new steps have been identified in relation to the four licensing objectives save as below.

Prevention of Crime and Disorder

No further risks have been identified which need to be addressed, save as below

1. Any person exercising a security activity (as defined by paragraph 2(1)(a) of schedule 2 of the Private Security Industry Act 2001) shall be licensed by the Security Industry Authority.
2. Such a person will be employed at the premises at the discretion of the designated premises supervisor/holder of the premises licence.
3. Any person as defined in condition (1) will clearly display his name badge at all times whilst on duty.
4. No customers apparently carrying open bottles upon entry shall be admitted to the premises at any times the premises are open to the public.
5. Where CCTV is installed with recording facilities such recordings shall be retained for a period of 30 days and made available within a reasonable time upon request by the police.
6. Alcoholic and other drinks may not be removed from the premises in open containers save for consumption in any external area provided for that purpose.
7. The use of door staff will be risk assessed by management on an ongoing basis and door staff will be employed at the premises at the discretion of the Designated Premises Supervisor/Premises Licence Holder. Door staff will be equipped with radio pagers.
8. Regular drugs checks will be made at the premises and the premises will operate a zero tolerance policy in relation to drugs.
9. The trading areas will be supervised by management and staff.
10. The premises will operate a recognised Proof of Age Scheme. Those appearing to be under eighteen will be asked to produce an accepted form of photographic identification.

Public Safety

No further risks have been identified which need to be addressed, save as below

1. To comply with the reasonable requirements of the fire officer from time to time.
2. To comply with the reasonable requirements of the building control officer.
3. The premises will have policies in place to ensure that spillages and breakages are dealt with promptly; all staff are trained and familiar with evacuation procedures; and staff will receive regular health, safety, alcohol and emergency training.

Prevention of Public Nuisance

